



A beautifully presented Victorian house set in this popular road on the edge of the town with a delightful garden.

- Hall
- Kitchen/breakfast room/family room
- Study
- Utility Room
- Cloakroom
- Principal bedroom with en suite shower room
- 2 Further bedrooms
- Bedroom 4/dressing room
- Family bathroom
- Parking
- Garden with Terrace
- Solar panels and a battery

£4,000 per calendar month to included garden maintenance

Coombe Hill Road,
East Grinstead, West Sussex. RH19



General

Availability: Immediate

Term: Minimum 6 months

Furnishing: Unfurnished

Restrictions: No smokers or dogs.

Heating: Gas heating

Outgoings: Utility accounts, including telephone and council tax are the responsibility of the tenants, who must also provide their own contents insurance

Local authority: Mid Sussex DC Tel: 01444 458166

Council Tax: Band G. EPC: Band D

Holding Deposit: Monies equivalent to one weeks rent will be required at acceptance of offer, but will be set against the first months rent. The tenant has 15 days to enter into a tenancy.

Deposit: Equal to five weeks reserved rent, payable prior to occupation

Directions: From our office proceed out of the town towards Standen. As you leave the town turn right into Coombe Hill Road. The house will be found after a short distance on the left on the corner with Medway Drive.

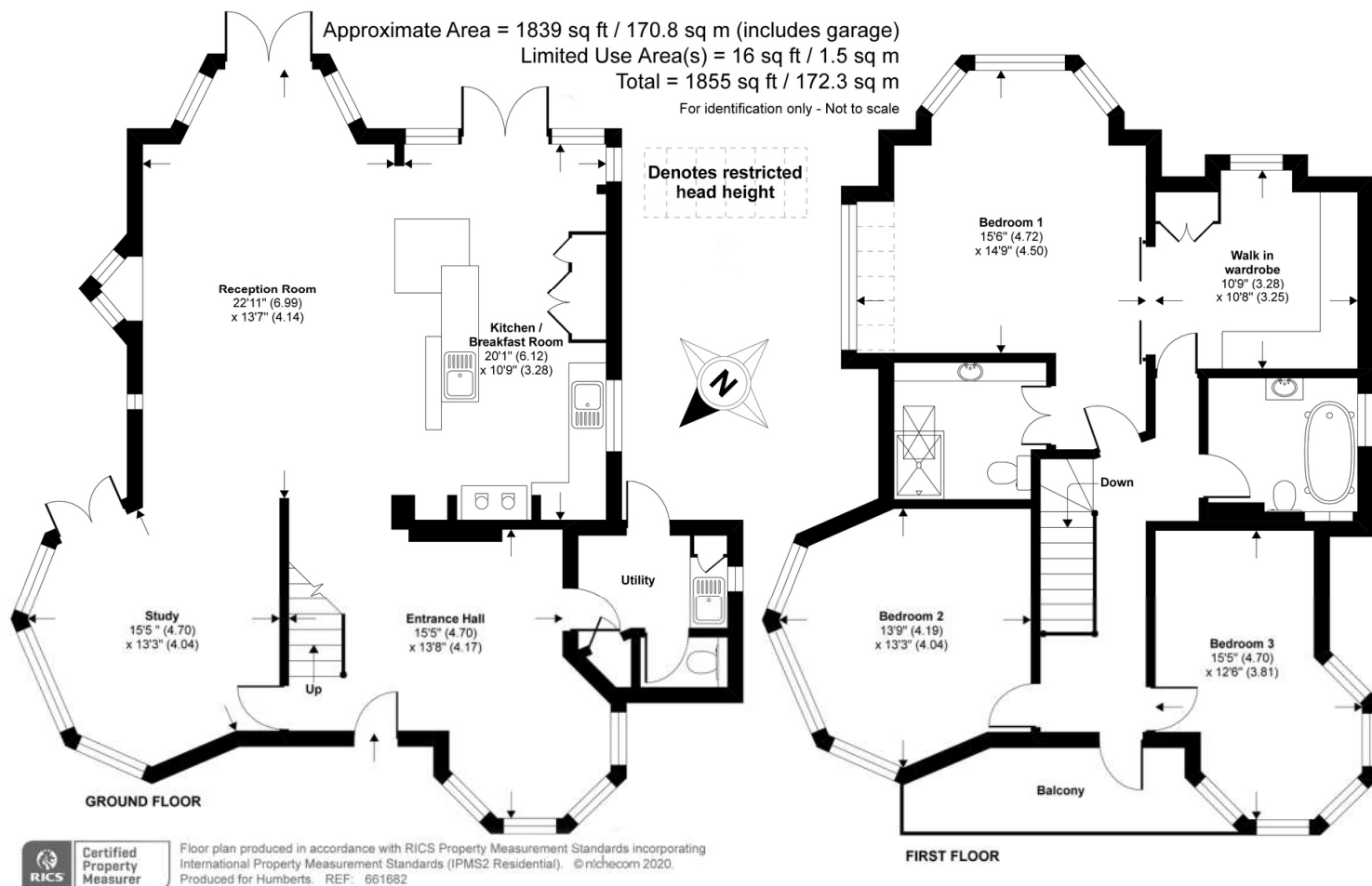

Simon Lewis Agencies Ltd trading as Humberts for themselves and for the vendor of this property whose agents they are, give notice that (i) these particulars do not constitute any part of an offer or contract, (ii) all statements contained within these particulars are made without responsibility on the part of Humberts or the vendor, (iii) whilst made in good faith, none of the statements contained within these particulars are to be relied upon as a statement or representation of fact, (iv) any intending purchasers must satisfy themselves by inspection or otherwise as to the correctness of each of the statements contained within these particulars, (v) the vendor does not make or give either Humberts or any person in their employment any authority to make or give representation or warranty whatsoever in relation to this property. Wide angle lenses may be used. Details 10/20. ©Copyright Humberts Group Limited

01342 326326 The Old Bakery, Lewes Road, Forest Row, East Sussex, RH18 5HA
forestrow@humberts.com

